

4 3 2 1

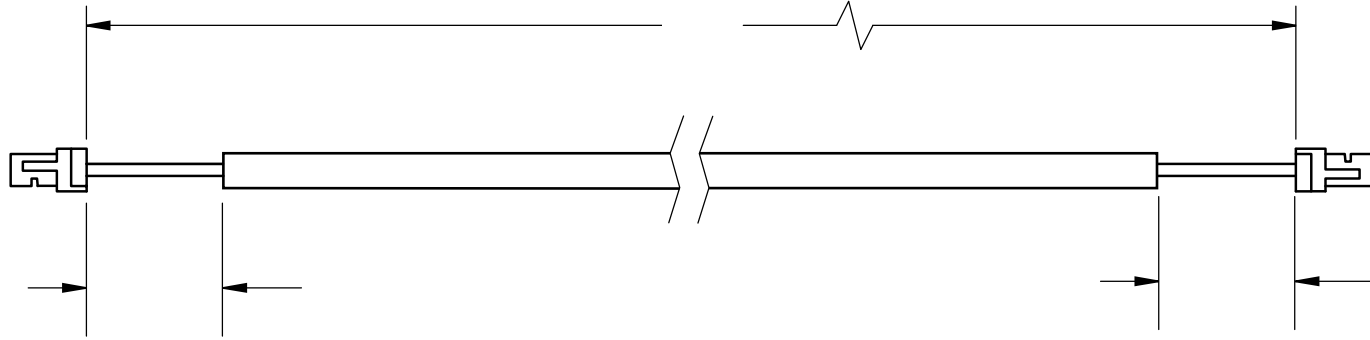

Notes:

- 1.) All units mm
- 2.) Connector 1 and Connector 2 are identical
- 3.) Do not label cable or connectors

Parts

Item	P/N
Housings	JST SHR-04V-S-B
Crimps	JST SSH-003T-P0.2-H
Wire	28 AWG (0.08mm ²) UL 1571 or equivalent (Ø0.8mm OD max, 30V 80° C min)
Sleeve	

Connection Diagram

Wire	Connector 1 pin	Connector 2 pin	Color	Notes
1	1	1	Red	
2	2	2	White	Twisted-pair with wire 3, 60-80mm per twist
3	3	3	Green	Twisted-pair with wire 2, 60-80mm per twist
4	4	4	Black	

TITLE

**C3 Daughterboard JST Cable
(with sleeve)**

SIZE

A

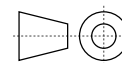

DRAWN BY

Pylon

MODIFIED BY

REV

2

SCALE 2:1

SHEET 1/1